

Licensing Panel (Licensing Act 2003 Functions)

Date: **14 September 2021**

Time: **10.00am**

Venue **Virtual**

Members: **Councillors: Deane, O'Quinn and Simson**

Contact: **Lesley Campbell**
Democratic Services Officer
lesley.campbell@brighton-hove.gov.uk

Agendas and minutes are published on the council's website www.brighton-hove.gov.uk.
Agendas are available to view five working days prior to the meeting date.

Electronic agendas can also be accessed through our meetings app available through
ModernGov: [iOS/Windows/Android](#)

This agenda and all accompanying reports are printed on recycled paper

AGENDA

1 TO APPOINT A CHAIR FOR THE MEETING

WELCOME & INTRODUCTIONS

2 PROCEDURAL BUSINESS

(a) **Declaration of Substitutes:** Where Councillors are unable to attend a meeting, a substitute Member from the Licensing Committee may attend, speak and vote in their place for that meeting.

(b) **Declarations of Interest:**

- (a) Disclosable pecuniary interests;
- (b) Any other interests required to be registered under the local code;
- (c) Any other general interest as a result of which a decision on the matter might reasonably be regarded as affecting you or a partner more than a majority of other people or businesses in the ward/s affected by the decision.

In each case, you need to declare

- (i) the item on the agenda the interest relates to;
- (ii) the nature of the interest; and
- (iii) whether it is a disclosable pecuniary interest or some other interest.

If unsure, Members should seek advice from the committee lawyer or administrator preferably before the meeting.

(c) **Exclusion of Press and Public:** To consider whether, in view of the nature of the business to be transacted, or the nature of the proceedings, the press and public should be excluded from the meeting when any of the following items are under consideration.

NOTE: *Any item appearing in Part Two of the Agenda states in its heading the category under which the information disclosed in the report is exempt from disclosure and therefore not available to the public.*

A list and description of the exempt categories is available for public inspection at Brighton and Hove Town Halls.

3 BRAZILIAN CENTRE LICENSING PANEL (LICENSING ACT 2003 FUNCTIONS)

7 - 50

Report of the Executive Director Housing Neighbourhoods & Communities (copy attached)

Contact Officer: Corinne Hardcastle
Ward Affected: Central Hove

Tel: 0127329

The City Council actively welcomes members of the public and the press to attend its meetings and holds as many of its meetings as possible in public. Provision is also made on the agendas for public questions to committees and details of how questions can be raised can be found on the website and/or on agendas for the meetings.

The closing date for receipt of public questions and deputations for the next meeting is 12 noon on the fourth working day before the meeting.

Meeting papers can be provided, on request, in large print, in Braille, on audio tape or on disc, or translated into any other language as requested.

Infra-red hearing aids are available for use during the meeting. If you require any further information or assistance, please contact the receptionist on arrival.

FURTHER INFORMATION

For further details and general enquiries about this meeting contact Thomas Bald, (01273 291065, email penny.jennings@brighton-hove.gov.uk) or email democratic.services@brighton-hove.gov.uk

WEBCASTING NOTICE

This meeting may be filmed for live or subsequent broadcast via the Council's website. At the start of the meeting the Chair will confirm if all or part of the meeting is being filmed. You should be aware that the Council is a Data Controller under the Data Protection Act 1998. Data collected during this web cast will be retained in accordance with the Council's published policy.

Therefore, by entering the meeting room and using the seats in the chamber you are deemed to be consenting to being filmed and to the possible use of those images and sound recordings for the purpose of web casting and/or Member training. If members of the public do not wish to have their image captured, they should sit in the public gallery area.

ACCESS NOTICE

The Public Gallery is situated on the first floor of the Town Hall and is limited in size but does have 2 spaces designated for wheelchair users. The lift cannot be used in an emergency. Evac Chairs are available for self-transfer and you are requested to inform Reception prior to going up to the Public Gallery. **For your own safety please do not go beyond the Ground Floor if you are unable to use the stairs.**

Please inform staff on Reception of this affects you so that you can be directed to the Council Chamber where you can watch the meeting or if you need to take part in the proceedings e.g. because you have submitted a public question.

FIRE / EMERGENCY EVACUATION PROCEDURE

If the fire alarm sounds continuously, or if you are instructed to do so, you must leave the building by the nearest available exit. You will be directed to the nearest exit by council staff. It is vital that you follow their instructions:

- You should proceed calmly; do not run and do not use the lifts;
- Do not stop to collect personal belongings;
- Once you are outside, please do not wait immediately next to the building, but move some distance away and await further instructions; and
- Do not re-enter the building until told that it is safe to do so.

Licensing Panel (Licensing Act 2003 Functions)

Brighton & Hove City Council

Item 3

Subject:	Application for a New Premises Licence under the Licensing Act 2003		
Premises:	Brazilian Centre 158 Church Road Hove BN3 2DL		
Applicant:	Brazilian Centre UK Ltd		
Date of Meeting:	14 September 2021		
Report of:	Executive Director of Housing, Neighbourhoods & Communities		
Contact Officer:	Name:	Emma Grant	Tel: (01273) 292381
	Email:	emma.grant@brighton-hove.gov.uk	
Ward(s) affected:	Central Hove		

FOR GENERAL RELEASE

1. PURPOSE OF REPORT AND POLICY CONTEXT

- 1.1 To determine an application for a New Premises Licence under the Licensing Act 2003 for Brazilian Centre.

2. RECOMMENDATIONS:

- 2.1 That the Panel determine an application for a New Premises Licence under the Licensing Act 2003 for Brazilian Centre.

3. CONTEXT/BACKGROUND INFORMATION & CONSULTATION

- 3.1 The application is for a New Premises Licence under the Licensing Act 2003. The application proposes a delicatessen and a butchers.
- 3.2 Section 18 (operating schedule) of the application is detailed at Appendix A and the plan is attached at Appendix B.
- 3.3 Summary table of proposed activities

	Proposed
Supply of Alcohol	Mondays to Saturdays 10:00 to 20:00 Sundays 10:00 to 17:00 Off the premises

Hours premises are open to public	Mondays to Saturdays 09:00 to 20:00 Sundays 09:00 to 17:00
--	---

3.4 Special Stress Area: The premises falls within the Special Stress Area. This area is deemed an area of special concern in terms of the levels of crime, disorder, and public nuisance experienced within them. (See paragraphs 3.2 – 3.2.5)

Representations received

3.5 Details of the representations made are notified to applicants on receipt by the Licensing Authority using a pro-forma. A summary appears below:

3.6 Two representations were received. They were received from Sussex Police and The Licensing Authority.

3.7 Representations received had concerns relating to Prevention of Crime and Disorder, Prevention of Public Nuisance, Protection of Children from Harm and to uphold the Statement of Licensing Policy.

3.8 Full details of the representations are attached at Appendix C. A map detailing the location of the premises is attached at Appendix D.

4. COMMENTARY ON THE LICENSING POLICY

4.1 The following extracts from Brighton & Hove City Council Statement of Licensing Policy are considered relevant to this application and **are numbered as they appear in the policy:**

1 Introduction

1.1 This Statement of Licensing Policy has been prepared in accordance with the provisions of the Licensing Act 2003 (the Act) and having regard to Guidance issued by the Home Office under Section 182 of the act. This policy takes effect from the 4th February 2021. The licensing authority is Brighton & Hove City Council. The purpose of this statement is to promote the licensing objectives and set out a general approach to making licensing decisions. The discretion of the licensing authority in relation to applications under the act is only engaged if ‘relevant representations’ are made by other persons or responsible authorities. This policy will inform the approach to be taken when deciding applications and imposing conditions when relevant representations are received. It is also intended as a guide for applicants as to what to include in their operating schedules, always recognising that if no representations are received, the application must be granted. The licensing authority must carry out its functions with a view to promoting the licensing objectives and this policy is framed around those objectives. Each application will be given individual consideration on its merit. The scope of this policy covers the following:

- Retail sales of alcohol.
- The supply of alcohol by or on behalf of a club, or to the order of, a member of the club.
- The provision of regulated entertainment.
- The provision of late night refreshment.

1.2 The licensing objectives are:

- (a) the prevention of crime and disorder.
- (b) public safety.
- (c) the prevention of public nuisance; and
- (d) the protection of children from harm.

1.3 Scope

1.3.1 Licensing is about regulating licensable activities on licensed premises, by qualifying clubs and at temporary events. Any conditions attached to various authorisations will be focused on matters which are within the control of individual licensees and others with relevant authorisations, i.e. the premises and its vicinity. Each application will be given individual consideration on its merit. Nothing in this policy shall undermine the right of any individual to apply under the terms of the act for a variety of permissions and to have any such application considered on its individual merits. Similarly, nothing in this policy shall override the right of any person to make representations on an application or seek a review of a licence or certificate where provision has been made for them to do so in the act.

3 Special Policies and Initiatives

3.2 Special Stress Area

3.2.1 The map below details the area of the city centre which borders the Cumulative Impact zone at 3.1.3 and which is deemed an area of special concern in terms of the levels of crime and disorder and public nuisance experienced within it. The area recommended for further monitoring and detailed guidance within the Special Policy comprise the following as pictured below delineated in purple:

Special Stress Area and Cumulative Impact Zone, January 2021

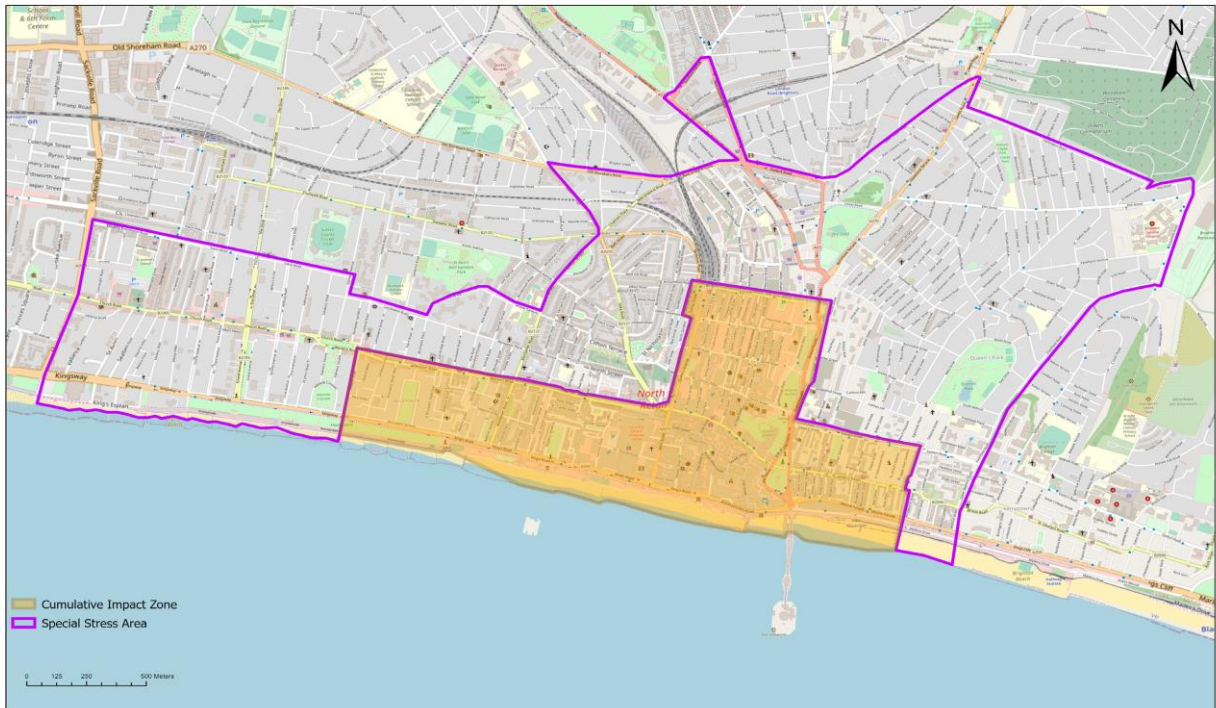

Brighton & Hove Public Health Intelligence, 2021
© OpenStreetMap (and) contributors, CC-BY-SA © Crown Copyright. All rights reserved. Licence: 100020999. Brighton & Hove City Council. 2019. Cities Revealed © 2018

The Special Stress Area - an area bounded by and including: The west side of Hove Street/Sackville Road, northwards to the intersection with the north side of Blatchington Road, along north side of Blatchington Road and Eaton Road, southwards at the junction onto the east side of Palmeira Avenue and then eastwards at the junction onto the north side of Landsdowne Road; eastwards to the junction with Furze Hill, along the north side Furze Hill to its end and then due east along the north side of Victoria Road to its junction with Montpelier Road (west side), north to where Montpelier Road joins Vernon Terrace then north to Seven Dials; north west along the west side of Dyke Road until the junction with the Old Shoreham Road, then East along the north side of Old Shoreham Road, continuing on the north end of New England Road, north west at Preston Circus at the junction of New England Road and Preston Road along the west side of Preston Road until the junction with Stanford Avenue then and north east along the north side of Stanford Avenue until the junction with Beaconsfield Road, south along the east side of Beaconsfield Road until the junction at Preston Circus and Viaduct Road, eastwards along the north side of Viaduct Road, then at the junction with Ditchling Road, North East along the north side of Upper Lewes Road until the junction with Lewes Road; south along the Lewes Road to junction with Hartington Road, along the north side of Hartington Road until the junction with St. Helen's Road, south into the north side of May Road, eastwards until its junction with Freshfield Road (east side), then south into Upper Bedford Street, into Bedford Street to the mean water mark south of Bedford Street, then due west until the mean water mark south of Lower Rock Gardens; North on Upper Rock gardens, to the north side of Eastern Road, west along Eastern Road and Edward Street until Grand Parade, north along the Eastern side of Grand Parade to the junction of York Place and Trafalgar Street, West along the Northern boundary of Trafalgar Street, up to and including Surrey Street and then South along the Western boundary of Queens Road to the junction with Air Street, West along the north side of Air Street, South-west to the junction of Western Road Brighton, then West along the North side of Western Road Brighton, South along the West side of Holland Road to the mean water mark south of Kingsway and Kingsway Esplanade as far as the west side of Hove Street/ Sackville Road.

3.2.2 This Special Stress Area (SSA) is of concern to the licensing authority because of the relatively high levels of crime and disorder and nuisance experienced within it. The area will be kept under review.

3.2.3 New and varied applications for premises and club premises certificates within the SSA will not be subject to the presumption of refusal, but operators will be expected to pay special attention when drawing up their operating schedules and to make positive proposals to ensure that their operation will not add to the problems faced in these areas. Appendix A of the SoLP sets out a list of potential measures the licensing authority considers may be appropriate. These may be more or less appropriate depending upon the style of operation applied for.

3.2.4 On receipt of any application in the SSA, where a relevant representation has been made, the licensing authority will scrutinise the application carefully and will look at the measures proposed in the operating schedules and compare them to the measures set out in Appendix A, Licensing Best Practice Measures. Where discretion has been engaged, those applications which fall short may be refused or conditions applied to comply with policy measures.

3.2.5 The Licensing Authority will keep the Cumulative Impact Zone and Special Stress Area under review. Should the authority find that problems of crime and disorder or nuisance are not improving, or are worsening, the Special Policy will be reviewed.

3.3 The Matrix Approach

The Licensing Authority will support:

3.3.1 Diversity of premises: ensures that there is a mix of the different types of licensed premises and attracts a more diverse range of customers from different age groups, different communities and with different attitudes to alcohol consumption. It gives potential for positively changing the ambience of the city or an area of it. This will have a positive effect in reducing people's fear of crime and in increasing the number of evening visitors to the city centre. The Community Safety Strategy recognises that too many single uses in a confined area and patrons turning out onto the streets at the same time may create opportunities for violent crime and public disorder and therefore supports mixed use venues encouraging a wider age balance.

3.3.2 A "matrix" approach to licensing decisions has been adopted and is set out below. It provides a framework of what the licensing authority would like to see within its area and gives an indication of the likelihood of success or otherwise to investor and businesses making applications.

Matrix approach for licensing decisions in a Statement of Licensing Policy (times relates to licensable activities)

	Cumulative Impact Area	Special Stress Area	Other Areas
Restaurant	Yes (midnight)	Yes (midnight)	Yes (midnight)
Café	Yes (10 pm)	Yes (10 pm)	Yes (10 pm)
Late Night Takeaways	No	Yes (midnight)	Yes (midnight)
Night Club	No	No	No
Pub	No	Yes (11pm)	Yes (midnight)
Non-alcohol lead (e.g. Theatre)	Yes (favourable)	Yes (favourable)	Yes (favourable)
Off-licence	No	No	Yes (Up to 11pm but if in densely residential area may be earlier – see note 7 below)
Members Club (club premises certificate)	Yes (<100 capacity) (11pm)	Yes (<100 capacity) (11pm)	Yes

Notes on matrix

Subject to the following notes, the policy, as represented in the matrix, will be strictly adhered to:

- 1) Each application will be considered on individual merit
- 2) Applications within the CIZ are subject to the special policy on cumulative impact at para 3.1, and those within the special stress area to the special stress policy considerations at para 3.2.
- 3) Departure from the matrix policy is expected only in exceptional circumstances
- 4) Exceptional circumstances will not include quality of management or size of venue except where explicitly stated in policy matrix.
- 5) Exceptional circumstances may include: consultation with and meeting requirements of responsible authorities, an appropriate corporate social responsibility policy, community contribution to offset impact (such as financial contribution to infrastructure), community support, alcohol sale ancillary to business activity (demonstrable to responsible authorities and licensing authority, for instance by licence condition allowing authorised officers access to sales accounts).

6) The following licensing activities are encouraged and valued by the licensing authority: outdoor regulated entertainment, community based street parties, members clubs, traditional pubs outside the city centre and non-alcohol led licensable activities, particularly within city centre.

7) Other Areas; consideration will be given to the nature of the area and location in relation to any application. In a residential area for example the concerns of local residents will be relevant when considering applications for off-licences, pubs or cafes, especially if there is evidence of anti-social behaviour, street drinking or underage drinking. Earlier closing times may be appropriate. Regard will be had to the Public Health Framework for assessing alcohol licensing on our website www.brighton-hove.gov.uk/licensingact.

8) In an area where there are already several existing off-licences or where the premises is situated within a parade with another off licence and where representations are received about negative cumulative impact on the licensing objectives of a further premises, the application may be refused on these grounds or restrictions placed on the terminal hour to reflect opening hours of other shops.

9) Outdoor events will be supported where arranged through the council's event planning process. Generally, regulated entertainment in the open air including tents and marquees should have a maximum closure hour of 2300. Earlier hours may be imposed in sensitive open spaces or near residential areas. The licensing authority will have regard to Noise Council guidance.

10) Non-alcohol led category does not include "alcohol in shared workplaces". It is recommended that sale of alcohol in shared workspaces should have a terminal hour of no later than 10pm. For further advice and guidance on "alcohol in shared workplaces" please see paragraph 3.3.4-3.3.6.

3.5 Off licences

In recent years there has been a noticeable shift towards more people buying alcohol from shops and drinking at home prior to going into premises such as pubs and clubs. The council is concerned that alcohol loading from off-licence sales is a significant problem in the city and adversely affects the licensing objectives as it gives rise to problems of drunkenness, disorderly behaviour and a higher risk of alcohol sales to children. Representations from the police, local residents and the director of public health at licensing panel hearings have testified to these problems and Information published in the Public Health Framework for assessing alcohol licensing presents a ward by ward analysis of crime and disorder and health data which is relevant in this respect.

3.5.1 The special policy on cumulative impact and the special stress areas apply to off licences as explained in the matrix approach at 3.3. But in general, where applications are made for new premises or variations to existing licences, and where the police or others make representations against the grant of a further licence for off sales, the council will give specific consideration to restricting the number, type, and the hours of premises selling alcohol exclusively for consumption off the premises. Decisions will be grounded in the Public Health Framework for assessing alcohol licensing. The council will want to be assured that the operating schedule of premises, and their overall management, training and levels of staffing,

are appropriate to ensure that the licensing objectives are promoted in what may be challenging circumstances. Retail outlets and stores where the provision of fresh produce is the principal product sold maybe considered more favourably.

3.5.2 The Licensing Authority encourage off licences to join the Council led “Sensible on Strength” scheme to reduce the availability of cheap super strength beers and ciders. Off licences voluntarily sign up not to sell cheap super-strength beers and ciders over 6% ABV and operate good practice measures (see 3.5.3) for which they receive an accreditation as a responsible retailer.

3.5.3 Areas of best practice that may be included in an Operating Schedule include

- the installation of a digital CCTV system by liaison with, and to a standard approved by Sussex Police
- Challenge 25 policy
- Refusals system
- Documented staff training including underage sales, drunkenness and proxy sales
- Voluntary restriction of high strength alcohol - operating schedules may be used to limit high ABV beers and ciders
- BCRP membership (or other accredited scheme)
- No sale of single cans
- Displays should not be located at the entrance/exit points or near checks out

3.5.4 The Licensing Authority and Sussex Police have specific concerns around the delivery of alcohol off the premises due to issues around the end location of delivery, age verification checks (Challenge 25), the increased possibility of the alcohol coming into the CIZ and SSA from other areas, as well as the personal safety of drivers when having to refuse a delivery at the end destination.

3.5.5 Alcohol delivery poses a unique set of challenges as it often transfers the final age verification to a person who has no responsibility in relation to the Premises Licence which authorised the sale of alcohol. A premises licence holder needs to be satisfied that their drivers or the delivery drivers of the third party company they chose to use, have received regular and comprehensive training in age verification and identifying persons who have consumed too much alcohol.

3.5.6 Evidence has shown that customers have previously used landmarks/businesses not related to them as addresses for delivery so that alcohol could be consumed in open spaces/parks. The risk being that this may lead to increased crime and disorder including anti-social behaviour and criminal damage, as well as the possibility that underage persons can gain access to alcohol. Concerns have also been raised about the delivery of alcohol to known street drinking hotspots. Therefore, a condition requiring all deliveries to be to a verifiable residential or business address and a face to face ID verification is vital in mitigating some of this risk.

3.5.7 While the Licensing Authority and Sussex Police recognise this is a growing area of business, new or variation applications to include the delivery of alcohol off the premises will be subject to increased scrutiny. Suggested conditions for the provision of an alcohol delivery service can be found at Appendix A. These are not exhaustive and each application will be considered on its own merits.

3.6 Street drinking

3.6.1 The Licensing Authority will have regard to areas highlighted by Sussex Police that are at risk from alcohol related anti-social behaviour. The nature of these areas can be fluid/seasonal and so updated maps and data will be produced regularly to ensure the information is current. These hot spot areas are considered high risk for street drinkers and the Licensing Authority will have regard to prevention of crime and disorder by virtue of street drinking and anti-social behaviour when considering applications in this area.

4 Prevention of Crime and Disorder

The following details and measures are intended to address the need for the prevention of crime and disorder which may be associated with licensed premises and certificated club premises. Conditions attached to licences and certificates will, as far as possible, reflect local crime reduction strategies.

- 4.1.1 The licensing authority acknowledges that training and good management play a key part in preventing alcohol and drug related crime. The authority expects that all licensees of on-licensed premises attend training programmes which will raise their awareness of the issues relating to drugs and violence in licensed premises, and that suitable training be extended to all bar staff and door supervisors so that drug dealers and users will be deterred from using licensed premises for illegal purposes and that incidents of violence in licensed premises will be reduced. Licensees are also encouraged to attend training programmes to help identify children at risk and issues of basic child protection. It is the duty of the designated premises supervisor (DPS) to train staff on induction concerning conditions on their premises licence.
- 4.1.2 It is expected that the DPS will spend a significant amount of time on the premises. When not on the premises it will be essential that the DPS is contactable, particularly should problems arise with the premises and that staff are authorised by the DPS.
- 4.1.3 The location of violent attacks, anti-social behaviour and hate crime or related incidents may be used to justify closing times.
- 4.1.4 Measures put in place should support the intentions of Operation Marble (police operational order), which aims to prevent incidents of crime and disorder within the night time economy, at weekends. Operation Marble operates with a view to minimising the risk to the public of being a victim of public place violent crime; to reduce incidents of violent crime and public disorder within the city centre; to deal positively with offences and offenders; to secure and preserve evidence which will assist in the prosecution of offenders and to support the night time economy and the responsibly run businesses within it.

4.2 Sussex Police

4.2.1 Sussex Police have a specific Operation relating to the night time economy called Operation Marble (detailed in 3.4.1) and work closely with partners to ensure a safe and vibrant city centre. There continues to be an increasing demand for resources

further into the early hours of the morning with the highest concentration of crimes occurring between 21:00 and 06:00 on a Friday into a Saturday and between 20:00 and 06:00 on a Saturday night into a Sunday. The data set used shows that up to 80% of arrests made in the timeframe 20:00 – 06:00 on these days were affected by alcohol. For full details of these statistics see the Cumulative Impact Assessment at Appendix E.

4.2.2 The dealing and use of drugs remains an issue across the city and Sussex Police welcome proactive policies from licensed premises. A drug safe and seizure recording initiative is in place of which further details can be obtained by contacting Brighton & Hove Police Licensing (brighton.licensing@sussex.pnn.police.uk). This initiative encourages licensed premises with Door Supervisors to search and seize drugs from persons attempting to enter their premises and ensures that once drugs are removed from persons, they can be safely collected and destroyed by Sussex Police.

4.2.3 Dispersal from the city centre during the late evening and early morning remains a policing challenge. Over recent years, there has been a proliferation of off-licences and late night refreshment venues along the city's arterial routes. This has led to incident 'hot spots' where patrons from the night time economy continue to interact, albeit away from any safety measures afforded by on-licences. As such, Sussex Police support the Council's Special Policy in offering guidance to both applicants and the Licensing Committee in relation to off-licences and late night refreshment licences.

4.2.4 Sussex Police have continuing concerns that, despite staff training in age-restricted sales, under age individuals are still being served alcohol both on and off the premises in some of the city's licensed premises. As such, regular intelligence-led 'test-purchase' operations are conducted to highlight premises where sales are taking place and ensure appropriate enforcement action is taken to prevent further sales. The introduction of identification scanning machines at premises throughout the city has proved successful in mitigating some risk, but operators must maintain vigilance regarding the fraudulent use of genuine IDs. Sussex Police continue to work alongside the Business Crime Reduction Partnership to tackle the problem of those who use false or another's identification to enter licensed premises and purchase alcohol.

4.2.5 Sussex Police work closely with venues and other organisations within the city to protect vulnerable people from becoming victims of crime. As well as work to prevent under age sales, vulnerability training is offered to identify persons who may have been made vulnerable through alcohol or drugs. Sussex Police also support initiatives such as (but not limited to) safe spaces, mobile teams of volunteers actively checking people's well-being and the Beach Patrol.

4.2.6 Public Space Protection Orders have proved an effective tool for Sussex Police in targeting enforcement action in problem areas of the city. It 'allows Police Officers and Police Community Support Officers to remove alcohol from any person in a public place if that person is involved in anti-social behaviour (ASB) or the officer believes that by having alcohol in their possession there is an increased risk of ASB. It is an offence to refuse to hand over alcohol when required to do so.' They have been particularly effective in the day time economy where members of the street community are causing ASB issues for members of the public and local

businesses, especially during the summer months where there is a large influx of visitors to Brighton & Hove.

4.2.7 Policing the night time economy continues to provide a challenge and in the climate of limited resources and newly emerging problems, Sussex Police support maintaining the council's Special Policy which defines cumulative impact and special stress and will continue to take enforcement action where appropriate if the actions of a Premises Licence Holder, Designated Premises Supervisor, Door Supervisors or Staff have fallen below the high standard expected across the city. Sussex Police also recognise and support businesses which are aware of their social responsibilities and as such, actively contribute towards keeping Brighton & Hove a safe and enjoyable city.

4.3 Care, control and supervision of premises

4.3.1 The Licensing authority supports the Business Crime Reduction Partnership and other approved schemes. Where appropriate, premises licence holders should be members of the BCRP for the deterrence to violent crime that such membership provides. The BCRP NightSafe radio scheme is normally expected as an operational requirement for city centre bars, clubs and pubs and is an example of good practice in achieving the aim of reducing crime and disorder and improving public safety. Well managed pub-watch schemes provide information exchange between the premises licence holders and responsible authorities that reduce and deter violent crime and disorder. The council will support a responsible licensing scheme.

4.3.2 The effective management and supervision of a venue is a key factor in reducing crime and disorder, both within it and outside. The police will consider the applicants, objecting to the application where appropriate. The police may suggest crime prevention measures in relation to, for example, the internal layout of the premises, closed-circuit television, help points, lighting and security staff. The police may ask for conditions which support such measures to be imposed when licensing applications are granted, eg type of licence, capacity, operating hours restrictions.

4.3.3 Following the grant of a licence, the management and supervision of the premises, in so far as it might impact on crime and disorder, will continue to be monitored. Particular attention will be paid to any licensed premises where there is evidence of criminal activity or any association with racist or homophobic crime. The licensing authority will keep itself well briefed on the nature, location and type of premises where alcohol related violence and disorder are occurring so it can take full account of the facts and avoid exacerbating problems as required by the Community Safety Strategy. Where licensed premises are found to cause nuisance or be associated with disorder or unreasonable disturbance, the review process may be invoked, and powers of revocation or the imposition of conditions may be considered. Conditions may include use of closed-circuit television, licensed door supervisors and earlier closing times. Such action to restrict the operation may be taken for trial periods to allow businesses an opportunity to remedy existing disorder, nuisance or disturbance.

4.3.4 This policy recognises the use of registered Door Supervisors All Door Supervisors will be licensed by the Security Industry Authority. Mobile security units and similar systems are in use by some premises operators as a means of providing security cover at very short notice at premises which may not normally require a permanent security presence. This policy endorses the use of units following such guidance and standards in appropriate circumstances.

4.3.5 The development of codes of practice and general operating standards for security companies is encouraged for local businesses; premises operators are urged to ensure that security services, when engaged, are provided by suitably qualified businesses operating to recognised standards and who should be working towards SIA accreditation.

4.3.6 Enforcement will be achieved by the enforcement policy appended (Appendix B).

6 Prevention of Public Nuisance

The following details and measures are intended to address the need for the prevention of public nuisance which may be associated with licensed premises and certificated club premises:

6.1.1 In determining applications for new and varied licences, regard will be had to the location of premises, the type and construction of the building and the likelihood of nuisance and disturbance to the amenity of nearby residents by reason of noise from within the premises, as a result of people entering or leaving the premises or from individuals or groups of customers gathered outside (eg in order to smoke).

6.1.5 In determining applications for new licences or extensions in hours or terminal hours of licensed premises, regard will be had to late night public transport availability and location of taxi ranks to aid dispersal of customers.

6.1.6 Reasonable controls are available to all premises operators to minimise the impact of noise from customers outside. The council's Environmental Health Department has issued guidance on a number of steps that can be taken in this respect which are endorsed by this policy (see 6.2 below).

6.2 Smoking Advice

6.2.1 Premises licence holders will be expected to:

- Develop a management plan on how to manage smoking on your premises and ensure that all staff are aware of the contents of this plan, and that it is effectively implemented. Noise from people smoking and talking can be intermittent, vary in character and volume and be intrusive. An effective smoking management plan will help prevent neighbours being disturbed.
- Comply with any planning conditions restricting the use of outdoor areas.
- Ensure that any structures used by smokers comply with the design criteria detailed in the Heath Act 2006 and that any structures, awnings, retractable canopies, etc. have the relevant planning permission.
- Ensure any new lighting to outdoor areas must be designed so as not to cause a light nuisance to neighbours and again have the relevant planning permission and building control consent.
- Ensure that the conditions on the premises licence are complied with. There may be conditions restricting the hours of use of gardens and outdoor areas. Having reviewed the contents of the premises licence you may find it necessary to request a variation of your licence.
- Licence tables and chairs on the Public Highway under the provisions of the Highways Act 1980. These licences may have conditions restricting the times that the area can be used.
- Ensure drinks, glasses and bottles are not taken onto the highway unless there is a tables and chairs licence permitting use. A system should be adopted to prevent theft and 'spiking' of drinks and reminding customers not to leave unattended items.
- Discourage smokers remaining in gardens and outdoor areas and determine terminal hours.
- Discourage smokers remaining outside by removing/disabling tables and chairs or prohibiting their use after a certain time. Lights and heaters will also be turned off.
- Introduce a system that after a certain time the number of smokers outside are restricted to a maximum number. Staff will be needed to manage this restriction.
- Employ staff and/or SIA registered door supervisors to manage doors and control customers and smokers entering and leaving the premises. Staff positioned on the doors can help to encourage customers not to cause a noise problem. It may be that staff are required to manage doors after a certain time, particularly during the hours when neighbouring residents are trying to sleep.
- Ensure door supervisors maintain order outside venues and protect customer safety. BCRP supports the use of Night Safe. Radio net and other pager systems and pub watch schemes can be used to provide for rapid police response and alert other venues where customers and staff are endangered.

- Position signs to remind customers that the premises is in an area where people live. It is not always obvious in busy commercial streets with flats above. By changing the design and wording of signs customers do not forget. Signs can be located in and outside the premises and on tables.
- Use CCTV to manage outside areas.

6.2.2 Licensed premises should normally display prominent, legible signs at exits reminding customers to leave in a quiet, peaceful, orderly manner.

7 Protection of Children from Harm

The following details and measures are intended to address the need for the protection of children from harm; this includes emotional and physical harm which may be associated with licensed premises and certificated club premises (for example the exposure too early to strong language and sexual expletives, eg in the context of film exhibitions or where adult entertainment is provided). It is intended that the admission of children to premises holding a premises licence or club premises certificate should normally be freely allowed without restricting conditions (unless the 2003 Act itself imposes such conditions or there are good reasons to restrict entry or to exclude children completely).

7.1.1 Licensees should note the concern of the authority that drink related disorder frequently involves under 18's. To prevent illegal purchases of alcohol by such persons, all licensees should work with a suitable 'proof of age' scheme and ensure that appropriate identification is requested prior to entry and when requesting alcohol, where appropriate. Appropriate forms of identification are currently considered to be those recommended by police, trading standards officers and their partners in the Licensing Strategy Group (eg passport, photo driving licence or pass card).

7.1.2 It is the licensing authority's expectation that all staff responsible for the sale of intoxicating liquor receive information and advice on the licensing laws relating to children and young persons in licensed premises. Licensed premises staff are required to take reasonable steps to prevent under age sales. The licensing authority will not seek to limit the access of children to any premises unless it is necessary for the prevention of emotional or psychological harm to them. Each application will be considered on its own merit but particular areas that will give rise to concern in respect of children are to be found in section 7.1.4 below.

7.1.3 To reduce alcohol-induced problematic behaviour by under 18 year olds, to enforce underage purchase and drinking laws and to assist in the protection of children from harm, the licensing authority supports the following measures:-

- a) Police should exercise powers (Confiscation of Alcohol (Young Persons) Act 1997) to remove alcohol from young people on the street
- b) Police and trading standards should implement test purchasing to reduce sales to under 18s in on and off sales licensed premises
- c) Further take-up of proof of age schemes will be promoted

d) In-house, mystery shopper type schemes operated by local businesses will be supported

e) Providers of events specifically catering for unaccompanied children should consider whether all staff at such events need to be DBS checked

7.1.4 The licensing authority will not seek to require that access to any premises is given to children at all times – under normal circumstances this will be left to the discretion of the licensee. The following areas give rise to concern in respect of children, who will normally be excluded from premises:

- where there have been convictions for serving alcohol to minors or with a reputation for underage drinking.
- with a known association with drug taking or dealing.
- where there is a strong element of gambling on the premises.
- where entertainment of an adult or sexual nature is commonly provided.
- where premises are used primarily or exclusively for the sale and consumption of alcohol and there is little or no seating for patrons.

Options may include:

- limitations on the hours when children may be present.
- age limitations (below 18).
- limitations or exclusions when certain activities are taking place.
- requirements for an accompanying adult.
- full exclusion of people under 18.

7.1.7 Trading standards and the police undertake ongoing enforcement operations around under-age sales and test purchasing. Sussex Police and BCRP undertake work concerning proxy purchases and counterfeit ID as part of the partnership support work with Community Safety and Trading Standards.

7.1.8 Trading standards have a programme of business support including training for local businesses to avoid under-age sales.

8 Integration of Strategies

8.1.1 The licensing authority shall secure the proper integration of this policy with local crime prevention, planning policy, transport, tourism and cultural strategies by:-

- Liaising and consulting with the Sussex Police, Community Safety Forum, Sustainability Commission representatives and following the guidance in community safety and crime and disorder strategy
- Liaising and consulting with Public and Alcohol Programme Board
- Liaising and consulting with the East Sussex Fire & Rescue Service
- Liaising and consulting with the Local Strategic Partnership, Safety Advisory Group (Emergency Planning) and Equalities and Social Justice Consultation Forum
- Liaising and consulting with the Planning authority
- Liaising and consulting with the Highways authority
- Liaising and consulting with local business and business associations. Having regard to any future documents issued relating to the Private Security Industry

Act 2001, for example liaison or information sharing protocols

- Liaising and consulting with the Trading Standards Team, for example with regard to test purchasing codes of practice

8.1.2 In line with statutory requirements and the council's Inclusion Policy, the Licensing Authority shall have due regard to the need to eliminate unlawful discrimination, and to promote equality of opportunity and positive relations between persons of diverse backgrounds, for example communities of interest such as: lesbian, gay, bisexual and transgender people; disabled people; racial and ethnic groups; religious and faith groups.

8.1.3 This policy supports the aims of the tourism strategy, recognising the benefits for the tourism economy of creating a safer and more attractive city centre and improving competitiveness with other European cities. The Licensing Committee should receive any reports relevant to the needs of the local tourist economy and the cultural strategy for the area to ensure that it considers these matters.

8.1.4 The Licensing Committee should receive relevant information relating to the employment situation of the area and the need for new investment and employment where appropriate.

8.1.5 Specific conditions may be attached to premises licences to reflect local crime prevention strategies. Such conditions may include the use of closed circuit television cameras, use of the NightSafe radio system or accredited scheme, the provision and use of shatterproof drinking receptacles, drugs and weapons search policy, the use of registered door supervisors, specialised lighting requirements, hours of opening. Certificates issued to club premises shall reflect local crime prevention strategies and may include any or all of the requirements listed above.

8.1.6 The licensing authority will have regard to the need to disperse people quickly and safely from the city centre to avoid concentrations which may produce disorder and disturbance.

8.3 Enforcement

8.3.1 The Enforcement of licensing law and inspection of licensed premises is detailed in the Protocol between Sussex Police, the East Sussex Fire & Rescue Service and Brighton & Hove City Council. This protocol reflects the need for more efficient deployment of Police and Local Authority staff commonly engaged in licensing enforcement and can be found at Appendix D (Lead Agency Status) of the Statement of Licensing Policy. In addition, the Licensing Authority will have regard to its published Licensing Enforcement Policy in making enforcement decisions in accordance with Brighton & Hove City Council's Statement of Licensing Policy (Appendix B). In order to better target enforcement resources, inspections will be undertaken outside of normal office hours and the sharing of information between all enforcement agencies will be encouraged through joint meetings or similar arrangements.

8.3.2 Attention is drawn to the targeting of agreed problem and high risk premises requiring greater attention as identified in the protocol. A number of other council and government policies, strategies and guidance documents must be taken into account to complement the policy, including:

- Community Safety & Crime Reduction Strategy
- Drugs and alcohol strategies – local alcohol harm reduction strategy
- Objectives of the Security Industry Authority
- The Anti-Social Behaviour Act 2003/ASBPC Act 2014
- The Health Act 2006
- The Violent Crime Reduction Act 2006
- Policing and Crime Act 2009

APPENDIX A – Licensing Best Practice Measures

Best Practice Measures to be included for consideration, in particular in SSA: Matters that would normally be expected in operating schedules:

- the adoption of a policy (e.g. Challenge 25) with acceptable proof of ID as per existing Statement of Licensing Policy
- all off sales to be made in sealed containers for consumption away from the premises
- a smoking policy which includes an assessment of noise and litter created by premises users
- the use of plastic or polycarbonate drinking vessels and containers, especially in outside areas or after specified hours
- a policy in relation to searching customers and for drugs, weapons, seized or lost and found property
- use of a refusals book for registering attempts to buy alcohol by under-age persons or refusals to those intoxicated
- the installation of a digital CCTV system by liaison with, and to a standard approved by, Sussex Police
- policies for dispersal of customers which may include signage regarding taxi services' telephone numbers and advice to respect neighbours and minimize noise

Items to which positive consideration would be given:

- membership of Business Crime Reduction Partnership, Pubwatch, Neighbourhood Watch or similar schemes
- use of 'Night Safe' radio system or similar accredited scheme
- regular training and reminders for staff in respect of licensing legislation, policies and procedures; records of which should be properly recorded and available for inspection
- records of regular checks of all parts of the premises in relation to drug use
- systems in place to ensure details of barred clients are exchanged with other operators
- giving an agreed minimum notice of special events (screening of major sports events, birthday parties, adult entertainment, etc.) to relevant authorities and use of appropriate additional measures at such events

Recommend best practice for both on and off premises

- Staff must be aware of the risk of the problem of proxy sales and offer assistance to responsible authorities to deter offences
- Signage on premises should set out legal duties

- Voluntary restriction of high strength alcohol – operating schedules may be used to limit high ABV beers and ciders
- Staff training – in addition to personal licence holders training, staff must be adequately trained for duties
- Challenge 25 would be the norm, particularly in the off licence trade
- Signage – proxy sale – deterrence

5. FINANCIAL & OTHER IMPLICATIONS:

Financial Implications:

- 5.1 The licensing Act 2003 provides for fees to be payable to the licensing authority in respect of the discharge of their functions. The fee levels are set centrally at a level to allow licensing authorities to fully recover the costs of administration, inspection and enforcement of the regime.

Finance Officer Consulted Michael Bentley

Date: 27/08/2021

Legal Implications:

- 5.2 The licensing authority must act to promote the four licensing objectives which are:
- The prevention of crime and disorder
 - Public safety
 - The prevention of public nuisance
 - The protection of children from harm

The licensing authority must have regard to its statement of licensing policy and the guidance issued by the Secretary of State in carrying out its functions.

Lawyer Consulted: Rebecca Sidell

Date: 27/08/2021

Equalities Implications:

- 5.3 Diversity is valued and strong, safe communities are vital to future prosperity. Licensing policy aims to protect children from harm including sale and supply of alcohol to children.

Sustainability Implications:

- 5.4 Licensing policy aims to prevent public nuisance and develop culture of live music, dancing and theatre.

SUPPORTING DOCUMENTATION

Appendices:

1. Appendix A –Section 18 (operating schedule) of the Application
2. Appendix B – Plan of Premises

3. Appendix C – Representations and emails from applicant addressing concerns in the representations.
4. Appendix D – Map of area

Documents in Members' Rooms

Brighton & Hove City Council, Licensing Act 2003: Statement of Licensing Policy 2021.

Home Office, Revised Guidance issued under section 182 of the Licensing Act 2003, April 2018.

Public Health Framework for assessing Alcohol Licensing. Annual Report – Ward. 5th edition. Public Health Intelligence. January 2019

Background Documents

Brighton & Hove City Council, Licensing Act 2003: Statement of Licensing Policy 2021.

Appendix B - Licensing Enforcement Policy

1.0 Statement of objectives

The council as licensing authority and responsible authority is committed to the council's priorities and will inform the enforcement actions taken. Amendments to priorities will be embedded automatically.

1.1

This service policy promotes efficient and effective approaches to regulatory inspection and enforcement that improve regulatory outcomes without imposing unnecessary burdens. This is in accordance with the Regulator's Compliance Code.

1.2

In certain instances the service may conclude that a provision in the code is either not relevant or is outweighed by another provision. It will ensure that any decision to depart from the code will be properly reasoned, based on material evidence and documented.

1.3

The service pursues a positive and proactive approach towards ensuring compliance by:

- Supporting the better regulation agenda;
- Helping make prosperity and protection a reality for the city's community;
- Helping and encouraging regulated entities to understand and meet regulatory requirements more easily;
- Responding proportionately to regulatory breaches; and
- Protecting and improving public health and the environment.

1.4

This policy is based on the seven 'Hampton Principles' of:

Economic Progress: Regulators should recognise that a key element of their activity will be to allow, or even encourage, economic progress and only to intervene when there is a clear case for protection;

Risk Assessment: Regulators, and the regulatory system as a whole, should use comprehensive risk assessment to concentrate resources in the areas that need them most;

Advice and Guidance: Regulators should provide authoritative, accessible advice easily and cheaply;

Inspections and other visits: No inspection should take place without a reason;

Information requirements: Businesses should not have to give unnecessary information or give the same information twice;

Compliance and enforcement actions: The few businesses that persistently break regulations should be identified quickly and face proportionate and meaningful sanctions; and

Accountability: Regulators should be accountable for the efficiency and effectiveness of their activities, while remaining independent in the decisions they take.

1.6

The rights and freedoms given under the Human Rights Act, particularly Article 6 and 8, will be observed, as will the provisions of the Regulation of Investigatory Powers Act.

2.0 Scope of the policy

2.1

This policy supports and supplements specific guidance on enforcement action contained in the Statutory Code of Practice for Regulators, Brighton & Hove City Council's Corporate Enforcement Policy, Statutory Codes of Practice and relevant guidance documents and guidelines issued by government departments and co-ordinating bodies.

2.2

This policy relates to actions taken to educate and enforce legislation where non-compliances have been identified or have a realistic potential to occur.

2.3

The policy is limited to those enforcement activities lead by the Head of Environmental Health & Licensing.

3.0 Training

3.1

Officers undertaking enforcement duties will be suitably trained and qualified so as to ensure they are fully competent to undertake their enforcement activities.

4.0 Management systems

4.1

The service will maintain management systems to monitor the quality and nature of enforcement activities undertaken, so as to ensure, so far as is reasonably practicable, uniformity and consistency.

5.0 Enforcement options

5.1

The service recognises the importance of achieving and maintaining consistency in its approach to enforcement. Statutory Codes of Practice and guidance issued by government departments, other relevant enforcement agencies or professional bodies will therefore be considered and followed where appropriate.

5.2

Sanctions and penalties will be consistent, balanced, fairly implemented and relate to common standards that ensure individual's, public safety or the environment is adequately protected. The aim of sanctions and penalties are to:

- Change the behaviour of the offender;
- Eliminate any financial gain or benefit from non-compliance;
- Be responsive and consider what is appropriate for the particular offender and regulatory issue, which can include punishment and the public stigma that should be associated with a criminal conviction;
- Proportionate to the nature of the offence and the harm caused; and
- Aim to deter future non-compliance.

5.3

Criteria to be taken into account when considering the most appropriate enforcement option include:

- the potential of the offence to cause harm;
- confidence in the offender;
- consequences of non compliance;
- likely effectiveness of the various enforcement options.

5.4

Having considered all the relevant options the choices for action are:

- **Informal Warning:** All advice issued will be given in writing and specify the nature of the breach or offence, and the actions required to remedy the issue. An informal warning may be included with the advice, and may accompany higher-level actions, such as Enforcement Notices or Voluntary Surrender:
- **Licence review:** Licence review power will be used where an application for review relates to one or more of the licensing objectives.

- **Taxi licence:** Taxi licence suspension or revocation will be used to protect public safety. Other sanctions such as DSA testing will be used to protect public safety and in accordance with the taxi licensing policy (Blue book).
- **Simple Caution:** The issue of a Simple Caution by an authorised officer may be undertaken as an alternative to prosecution where it is considered unnecessary to involve the courts, and the offender's response to the problem makes repeat offending unlikely, or the offender's age or health make it appropriate. Cautions may only be issued where the offender makes a clear and reliable admission of guilt and understands the significance of acceptance.
- **Prosecution:** A prosecution is appropriate where there is a breach of a legal requirement, such that public safety, health, economic or physical well-being or the environment or environmental amenity is adversely affected. The Crown Prosecutor's Code of Evidential and Public Interests tests must be met in all cases. However, certain circumstances will normally justify prosecution to prevent the undermining of the service's enforcement responsibilities.
 - Failure to comply with an Enforcement Notice
 - Declining a Simple Caution
 - Continued, reckless, negligent or pre-meditated non-compliance.
 - Failure to pay a fixed penalty.
 - Non-cooperation, acts of obstruction or threats of physical harm or abuse.
- **Injunctions:** Injunctive action as a means of preventing an activity or course of action likely to result in significant risk to public or community safety or economic wellbeing of consumers and businesses.

5.5

If the department is considering taking enforcement action which it believes may be inconsistent with that adopted by other authorities, the matter will be referred to the appropriate local co-ordinating body.

6.0 Informal warning

6.1

Informal action may be taken when:

- the act or omission is not serious enough to warrant formal action, or
- from the individual's/enterprise's past history it can be reasonably expected that informal action will achieve compliance, or
- confidence in the individual/enterprise's management or ability to resolve the matter is high, or
- the consequences of non-compliance will not pose a significant risk to public health, public safety, animal welfare or the environment.

6.2

When an informal approach is used to secure compliance with regulations, written documentation issued will:

- contain all the information necessary to understand what is required and why;
- indicate the regulations contravened, measures which will enable compliance with legal requirements and that other means of achieving the same effect may be chosen;
- clearly differentiate between legal requirements and recommendations of good practice. Such a differentiation will also be made when verbal advice is given.

7.0 Simple cautions

7.1

A Simple Caution may be issued as an alternative to a prosecution. Cautions may be issued to:

- deal quickly and simply with less serious offences;
- divert less serious offences away from the courts;
- reduce the chances of repeat offences.

7.2

The following factors will be considered when deciding whether a caution is appropriate:-

- evidence of the suspect's guilt
- has a clear and reliable admission of the offence been made either verbally or in writing
- is it in the public interest to use a caution as the appropriate means of disposal when taking into account the public interest principles set out in the Code for Crown Prosecutors.
- the suspected offender must understand the significance of a simple caution and give an informed consent to being cautioned.

7.3

No pressure will be applied to a person to accept a Simple Caution.

7.4

The 'cautioning officer' will be the most appropriate officer from Service Director, Service Assistant Director, Head of Service Environmental Health Manager or Licensing Manager. The Cautioning Officer must not have taken an active part in investigating the case.

7.5

Should a person decline the offer of a simple caution a prosecution will be recommended.

8.0 Prosecution

8.1

The department recognises that the decision to prosecute is significant and could have far reaching consequences on the offender.

8.2

The decision to undertake a prosecution will be taken after proper consultation in accordance with the Scheme of Delegation for the council's functions. The decision to proceed with a prosecution will normally be taken following legal advice. The matters to be taken into account when deciding if the issue of proceedings is proportionate include:

- the seriousness and nature of the alleged offence;
- the role of the suspect in the commission of the offence;
- any explanation by the suspect or any agent or third party acting on their behalf;
- was the suspect in a position of trust, responsibility or authority in relation to the commission of the offence;
- is there evidence of premeditation or disregard of a legal requirement for financial reward;
- risk of harm to the public, an individual or the environment;
- relevant previous history of compliance;
- reliability of evidence and witnesses
- any mitigating or aggravating circumstances or the likelihood that the suspect will be able to establish a defence;
- suspect's willingness to prevent a recurrence of the offence;
- the need to influence future behaviour of the suspect;
- the likely penalty to be imposed; and
- a prosecution is in the public interest, there is realistic prospect of conviction and sufficient evidence to support proceedings.

8.3

All relevant evidence and information will be considered before deciding whether to instigate proceedings in order to enable a consistent, fair and objective decision to be made.

8.4

Where an act or omission is capable of constituting both a summary and either way offence, when deciding which offence to charge the following will be considered:

- the gravity of the offence;

- the adequacy or otherwise of the powers of the summary court to punish the offence;
- the record of the suspect;
- the suspect's previous response to advice or other enforcement action;
- the magnitude of the hazard;
- any circumstances causing particularly great public alarm;
- comments from the council's Solicitor's Office.

8.5

As a general rule an individual or business will be given a reasonable opportunity to comply with the law although in some circumstances prosecution may be undertaken without giving prior warning, e.g.

- the contravention is a particularly serious one;
- the integrity of the licensing framework is threatened.

9.0 Home Office and Government Advice: Problem premises on probation

9.1

The licensing authority supports the strategies of interventions and tough conditions to be assembled into packages released in 2008. The current version is appended (appendix A).

10.0 Appeals

If any person is unhappy with the action taken, or information or advice given they will be given the opportunity of discussing the matter with the relevant team manager, Head of Service or Assistant Director.

Any such appeal does not preclude any aggrieved person from making a formal complaint about the service or any officers. Any such complaint will be dealt with in accordance with corporate procedures and guidance.

Complaints that are not dealt with by the council's complaints procedure are listed in corporate policy and include:

- Complaints where the complainant or another person has commenced or intends to commence legal proceedings against the council.
- Complaints where the council has commenced or intends to commence legal proceedings against the complainant or another person relating to the matter of complaint

11.0 Shared enforcement roles

Lead agency status between Sussex Police, East Sussex Fire and Rescue Service and the council's trading standards, environmental health and licensing officers are determined between the agencies at county level. The current position is appended (appendix H).

APPENDIX A

Section 18 of 21

LICENSING OBJECTIVES

Describe the steps you intend to take to promote the four licensing objectives:

a) General – all four licensing objectives (b,c,d,e)

List here steps you will take to promote all four licensing objectives together.

CCTV WILL BE INSTALED WITH 31 DAYS DATA. STAFF TRAINING REGARDING THE FOUR LICENSE OBJECTIVES, UNDER 25 CHALLENGES, SIGNAGE LIKE NO PROOF NO SALE, REFUSAL BOOK, STAFF TRAINING RECORDS. DRUNK OR VIOLENT CUSTOMERS WILL NOT BE ABLE TO BUY ANY ALCOHOL DRINKS. WE WILL HAVE A FIRE AND HEALTH SAFETY RISK ASSESSMENT. WE WILL PARTICIPATE IN PUB WATCH MEETINGS OR WITH OTHER SIMILAR LOCAL ASSOCIATIONS. ALCOHOL DRINKS WILL BE STORED AWAY FROM CHILDRENS. SIGNAGE WITH THE SALE OF ALCOHOL HOURS WILL BE DISPLAYED. BEER/CIDER/ALE WILL NOT EXCEED 6 % ABV. NO SALE OF MINIATURES OF SPIRITS

b) The prevention of crime and disorder

CCTV WITH DATA FOR 31 DAYS. THE BUSINESS WILL HAVE ALWAYS A STAFF MEMBER THAT IS FAMILIAR WITH THE CCTV OPERATION. DRUNK CUSTOMERS WILL NOT BE ABLE TO PURCHASE ALCOHOL DRINKS. DPS AND PREMISES LICENSE HOLDER WILL PARTICIPATE IN PUB WATCH OR WITH OTHER SIMILAR LOCALS ASSOCIATIONS. OUR BUSINESS WILL NOT ENGAGE WITH IRRESPONSABLE ALCOHOL PROMOTIONS.

c) Public safety

CCTV WITH DATA FOR 31 DAYS WILL BE INSTALED. WE WILL HAVE A FIRE RISK ASSESSEMENT AND ALSO HEALTH SAFETY RISK ASSESSEMENT. ALCOHOL TO BE STORED IN A COOL DRY PLACE AND AWAY OF ANY HEAT SOURCE. NO IRRESPONSABLE PROMOTIONS. WE WILL IMPLEMENT ANY RECOMMENDATIONS GIVEN BY THE POLICE AND OTHER AUTHORITIES. DPS AND PREMISES LICENSE HOLDER WILL PARTICIPATE IN PUB WATCH MEETINGS OR WITH OTHER SIMILAR LOCALS ASSOCIATIONS

d) The prevention of public nuisance

DELIVERIES DONE BY OUR SUPPLIERS WILL TAKE PLACE WITHIN THE RECOMENDED TIMES BY THE AUTHORITIES. RUBISH BIN COLLECTION WILL TAKE PLACE WITHIN THE RECOMMENDED HOUR BY THE AUTHORITIES. STAFF MEMBER TO CLEAN ANY RUBISH OR LITTERING IN FRONT OUR PREMISES DURING THE DAY ON A REGULAR BASIS. ALCOHOL TO BE SOLD IN SEALEAD CONTAINERS.







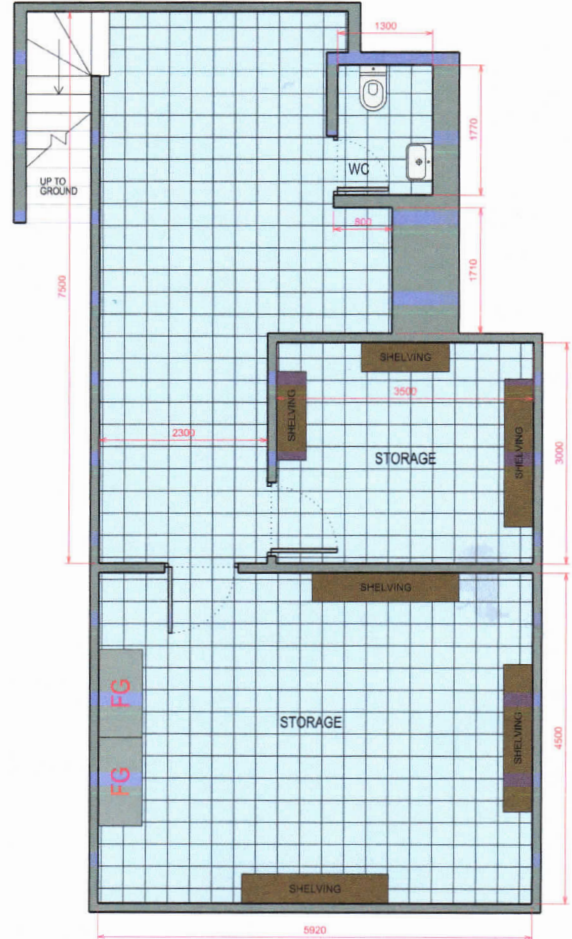
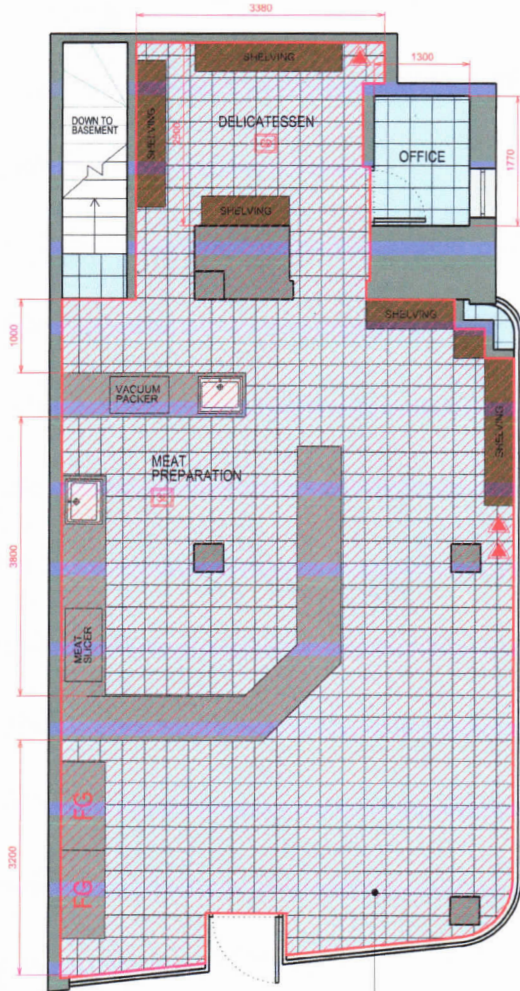











e) The protection of children from harm

STAFF WILL BE TRAINED REGARDING THE PROTECTION OF CHILDREN FROM HARM. OUR BUSINESS WILL HAVE A UNDER 25 CHALLENGE POLICY. NO PROOF, NO SALE. SIGNAGE AND POSTERS WILL GO UP. STAFF TRAINING RECORDS. REFUSAL BOOK. REFRESHER TRAINING EVERY 6 MONTHS TO ALL STAFF

APPENDIX B



Alcohol licensable area
Off Licence

- | | | | | | |
|---|---|---|--|--|-------------------|
|  APPLICATION AREA |  1 Hour fire compartment |  Emergency light & exit sign |  Smoke detector | FF Fridge frzer | GR Grill |
|  All fire doors to be 30/30 with self closers and intumescent strips |  Fire blanket |  Emergency lighting |  Gas Interlock System | FG Fridge | FY Fryer |
|  |  9 Litre water fire extinguisher |  Primary escape route |  Fire Alarm Control Panel | FZ Freezer | FD Fridge Display |
| |  5kg CO2 Extinguisher |  Secondary escape route |  Central alarm | OV Oven | CK Cooker |
| |  Fire door locked (5mm letters) |  Heat detector (To BS5839) |  CCTV |  CCTV | TO Toaster |

Butchers and Delicatessen
Alcohol Licence - Off Licence
Ground and Basement Floor Plans
Jose Manuel Rocha
Unit 35 Battersea Business Centre 99-109 Lavender Hill London SW11 5QL
Tel: +44 (0) 7868 697778 - Email: manuelrocha01@hotmail.com



Applicant
Brazilian Centre Brighton,
158 Church Road,
Hove, Sussex,
BN3 2DL

Number
JR_130_001

Scale @ A4 / A2
1:100 / 1:50

Date
16/06/21

APPENDIX C

REDACTED TEXT

Licensing Officer

Licensing Team

BHCC

Bartholomew House

Bartholomew Square

Brighton

BNI IJP

Date: 12th August 2021

Our Ref: 2021/01330/LICREP/EH

Phone: 01273 **REDACTED TEXT**

Email:

REDACTED TEXT

EG CON ENDS 17.08.21 VALID PCD, PPN & SOLP (A)

Dear **REDACTED TEXT**,

Re: Licensing Act 2003 - Representation regarding the application for a New Application for a Premise Licence For: Brazilian Centre, 158 Church Road, Hove, BN3 2DL. Reference: 2021/02446/LAPREN

I refer to the application made by Brazilian Centre UK Limited, for a new Premises Licence to be issued for the above premises. The Licensing Team, in its role as a Responsible Authority, has concerns about this application and therefore I am submitting this representation on the grounds of the prevention of crime & disorder and public nuisance and to uphold our Statement of Licensing Policy (SoLP).

The applicant has applied for a Premises Licence for alcohol for consumption off the premises Monday – Saturday from 10.00-20.00 hrs and on Sundays from 10.00-17.00 hrs. The opening hours are listed as 09.00-20.00 Monday to Saturday and 09.00-17.00 on Sundays. The premises is described on the application form as a delicatessen and a butcher.

This representation is submitted as there are concerns that the application does not meet the requirements of the Council's SoLP, with regard to applications made within the Special Stress Area of the city. The Special Stress Area is of concern to the Licensing Authority because of the relatively high levels of crime and disorder and nuisance experienced within it and we believe that the granting of this application could lead to increased associated issues with regard to crime & disorder and public nuisance in the nearby surrounding area.

The Council's SoLP includes a Matrix Model approach for licensing decisions, which recognises the diverse operation and different risks presented by different classes of licensed premises. It provides a vision of what the licensing authority would like to see within its area and gives an indication of likelihood of success or otherwise to investors and local businesses making applications.

The Matrix Model, on page 18 of the Council's SoLP, states that in the Special Stress Area, there should be no new off-licence Premises Licence applications granted. The policy does state that each application is still considered on its individual merit and there is discretion to depart from the policy where justified. However, departure from the Matrix Model is only expected in exceptional circumstances.

The premises is in the Special Stress Area and is located in the electoral ward of Central Hove, which according to our Public Health Framework for Assessing Alcohol Licensing (5th edition- January 2019) is ranked the 4th worst out of 21 wards under Crime and Disorder data for Police Recorded Alcohol related incidents. On the Health data Central Hove ward ranks the 4th worst for Alcohol suspected ambulance call outs and A&E attendances with a record of alcohol.

We maintain that the Matrix Model states that no new off-licence applications should be granted in the Special Stress Area and therefore invite a Sub-Committee Panel to decide the outcome of this application on behalf of the Licensing Authority and whether the applicant has demonstrated whether there are exceptional circumstances to depart from our policy.

Yours sincerely

REDACTED TEXT

REDACTED TEXT

Licensing Officer,

Licensing Team,

Regulatory Services.

Police Station
John Street
Brighton
BN2 0LA

Tel: **REDACTED TEXT**

Email: **REDACTED TEXT**

12th August 2021

The Licensing Technical Support Officers
Environmental Health, Brighton & Hove City Council
Bartholomew House, Bartholomew Square
Brighton, East Sussex
BN1 1JP

EG CON ENDS 17.08.21 VALID PCD, PCH & SOLP (B)

Dear **REDACTED TEXT**,

RE: APPLICATION FOR A NEW PREMISES LICENCE FOR BRAZILIAN CENTRE BRIGHTON, 158 CHURCH ROAD, HOVE, BN3 2DL UNDER THE LICENSING ACT 2003.

I write on behalf of the Chief Officer of Police for Sussex to raise a representation against the grant of the above application on the grounds of the prevention of crime and disorder and protection of children from harm. We also make reference to the Brighton & Hove City Council (BHCC) Statement of Licensing Policy.

This is a proposed new licence application in the City's Special Stress Area (SSA) which seeks the following hours and licensable activities:

Supply of alcohol (Off Sales)

Monday to Saturday: 10:00 – 20:00

Sunday: 10:00 – 17:00

Opening hours

Monday to Saturday: 09:00 – 20:00

Sunday: 09:00 – 17:00

The licensing decision matrix on page 16-17 of the Council Statement of Licensing Policy (SoLP) states that new premises applications or premises licence variations asking solely for the 'off' sale of alcohol in the SSA are indicated as a 'No' under the matrix.

While the applicant acknowledges the licensing objectives there is no mention of the special stress area in the application, and the concerns relating to crime and disorder surrounding this area.

Church Road suffers from a degree of crime and disorder. The local area including Hove Lawns has pre-existing issues around high levels of alcohol consumption and anti-social behaviour both of which could potentially be added to with an additional premises with off sales.

There are already a high number of off licenses in the local area as well as a number of restaurants and public houses.

Sussex Police would also be concerned that any alcohol purchased from the premises is very likely to be taken and consumed within the SSA and possibly into the CIZ increasing the risk of anti-social behaviour in the city where many incidents that arise are alcohol fueled. Sussex police feel further incidents may occur as conditions were not offered not to stock over 6% ABV Beers, Ciders and Lagers, or not to sell single cans.

Sussex Police have been working to reduce the anti-social behavior around Hove lawns and part of this is due to youths gathering in the area with alcohol, therefore earlier this year a test purchase operation was conducted within this area of Hove and a significant number of off licenses sold to our under age volunteers highlighting an issue in this area.

The applicant has not referred to the BHCC Statement of Licensing Policy (SoLP) in their application or offered anything that Sussex Police believe constitutes any reasoning why the SoLP should be departed from. Further, the applicant did not seek consultation with Sussex Police prior to submitting their application and so no further mitigation or exceptional circumstances have been discussed or offered.

Therefore, Sussex Police do not believe that the applicant has offered significant reasoning as to why this would be an exception or why the SoLP should be departed from.

Sussex Police invite the Licensing Authority to seriously consider refusing this application.

Yours sincerely,

REDACTED TEXT

Response & Operations

Brighton & Hove Division

Sussex Police

Please address all future correspondence to Brighton & Hove Licensing Unit, Police Station,
John Street, Brighton, BN2 0LA.

APPLICANT'S RESPONSE TO THE REPRESENTATIONS

From: REDACTED TEXT

Sent: 18 August 2021 23:14

To: EHL Safety <EHL.Safety@brighton-hove.gov.uk>

Subject: Fw: New Premises License - for Brazilian Centre - Hove - OFF License -,Police Representation

From: REDACTED TEXT

Sent: 18 August 2021 22:13

To: REDACTED TEXT

Subject: New Premises License - for Brazilian Centre - Hove - OFF License -,Police Representation

Dear **REDACTED TEXT**

I read your representation and I understand your concerns.

I'm aware that our business is in a SSA Area. Also, because of this pandemic, during more than a year, all Business ON Licenses can sell alcohol OFF License with no need to apply for a Variation. At least until the end of September 2021. This has some impact on street drinking.

Brazilian Centre is a Butcher and delicatessen specialized in Portuguese and Brazilian Products. This is our first shop in Brighton, and we would like to expand. We apply for what you think are reasonable hours.

We have another 3x shops in London. We are not a typical OFF License Shop and, we are not part of a big chain. Most of our products we would like to sell will be Portuguese Wine /Beers and some spirits. Sale of Alcohol OFF License will be a complement of our activity. The alcohol display in our shelves will not exceed 15% to 20%. The alcohol to be sold is not cheap.

We proposed robust measures to protect the 4 x License Objectives, some of these measures are:

Under 25 Challenge

Refusal/ Incident book

No Proof, No Sale Poster will be displayed at the window and inside the shop

Signage regarding the Under 25 will be displayed

Signage reminding customer that buying alcohol to Under 18 it's an offence will be displayed

Staff Training regarding the Sale of Alcohol to all new staff Members - Details of that Training will be recorded

All staff will have a refresher training every 6 x months (Sale of Alcohol)

CCTV will be installed with a memory data for 31 days. We will always have a staff member that will be familiar with the CCTV operation. Images will have good quality

No Sale of Small bottles of Spirits (Minimum will 700/750ml)

Alcohol will be bought from Approved Suppliers AVRS -

Signage saying Illegal Traders will be reported to the authorities

Deliveries and Rubbish Collection to be done by the recommended times from the Council

-

Signage regarding the Sale Of Alcohol Hours will be displayed on the shop window, and at the Counter, and where the alcohol will be displayed.

The Alcohol will be covered by a curtain during “No Sale of alcohol Hours “
Costumers will not be allowed to take any open bottles or cans outside of our premises
Premises License Holder/DPS will participate in Pub Watch or with other Local Crime
Prevention Associations.
Drunk and Violent Costumers will not be able to purchase any Alcohol Drinks
Cans or Drinks of Beers/Ales/Ciders/ Souts on sale will not Exceed 6% % ABV. And will be
sold in packs of 4/6 x minimum
Alcohol exposed on shelves will not exceed 20%, 80% of the products will be Dry Goods
and other deli products
No Irresponsible Promotions
Beers/Cidges and Ales will not be stored in fridges
We welcome recommendations given by the Local Authorities and the Police

I'm convinced with these measures we will implement we will not increase street drinking.
Our customers will buy meat, groceries and eventually wine or beers and will take to their
homes. Not to drink on the street.

Kind Regards

REDACTED TEXT

From: REDACTED TEXT

Sent: 18 August 2021 23:09

To: REDACTED TEXT EHL Safety <EHL.Safety@brighton-hove.gov.uk>

Subject: Premises License Application for Brazilian Centre - OFF License

Dear **REDACTED TEXT**

I read your representation and I understand your concerns.

I'm aware that our business is in a SSA Area. Also, because of this pandemic, during more
than a year, all Business ON Licenses can sell alcohol OFF License with no need to apply for
a Variation. At least until the end of September 2021. This has some impact on street
drinking.

Brazilian Centre is a Butcher and delicatessen specialized in Portuguese and Brazilian
Products. This is of first shop in Brighton, and we would like to expand. We apply for what
you think are reasonable hours.

We have another 3x shops in London. We are not a typical OFF License Shop and, we are
not part of a big chain. Most of our products we would like to sell will be Portuguese Wine
/Beers and some spirits. Sale of Alcohol OFF License will be a complement of our activity.
The alcohol display in our shelves will not exceed 15% to 20%. The alcohol to be sold is not
cheap.

We proposed robust measures to protect the 4 x License Objectives, some of these
measures are:

Under 25 Challenge

Refusal/ Incident book

No Proof, No Sale Poster will be displayed at the window and inside the shop

Signage regarding the Under 25 will be displayed
Signage reminding customer that buying alcohol to Under 18 it's an offence will be displayed
Staff Training regarding the Sale of Alcohol to all new staff Members - Details of that Training will be recorded
All staff will have a refresher training every 6 x months (Sale of Alcohol)
CCTV will be installed with a memory data for 31 days. We will always have a staff member that will be familiar with the CCTV operation. Images will have good quality
No Sale of Small bottles of Spirits (Minimum will 700/750ml)
Alcohol will be bought from Approved Suppliers AWRS -
Signage saying Illegal Traders will be reported to the authorities
Deliveries and Rubbish Collection to be done by the recommended times from the Council

-
Signage regarding the Sale Of Alcohol Hours will be displayed on the shop window, and at the Counter, and where the alcohol will be displayed.

The Alcohol will be covered by a curtain during "No Sale of alcohol Hours "

Customers will not be allowed to take any open bottles or cans outside of our premises
Premises License Holder/DPS will participate in Pub Watch or with other Local Crime Prevention Associations.

Drunk and Violent Customers will not be able to purchase any Alcohol Drinks

Cans or Drinks of Beers/Ales/Ciders/ Souts on sale will not Exceed 6% % ABV. And will be sold in packs of 4/6 x minimum

Alcohol exposed on shelves will not exceed 20%, 80% of the products will be Dry Goods and other deli products

No Irresponsible Promotions

Beers/Ciders and Ales will not be stored in fridges

We welcome recommendations given by the Local Authorities

I'm convinced with these measures we will implement we will not increase street drinking. Our customers will buy meat, groceries and eventually wine or beers and will take to their homes. Not to drink on the street.

Kind Regards

REDACTED TEXT

APPENDIX D



